

walker laird

solicitors and estate agents



0/3, 11 Mulberry Crescent

Renfrew | PA4 8FJ

[walkerlaird.co.uk](http://walkerlaird.co.uk)

The perfect blend of convenience, comfort and style. This contemporary Flat at Mulberry Crescent occupies the ground floor within a short distance of Braehead and the River Clyde. This property ticks all the boxes for modern living.

The accommodation comprises: well-appointed Hallway complete with storage space; open plan Lounge/Dining/Kitchen incorporating white gloss units, an oven, gas hob, extractor and integrated fridge freezer; two spacious Bedrooms; Master En-Suite with electric shower; and a Wet Room featuring a white w.c, floating basin, mains shower and heated towel rail.

There are fitted wardrobes in the main bedroom which is carpeted. The majority of the property is laid out with modern laminate flooring. The property has been freshly decorated in neutral tones throughout.

Further benefits include: gas central heating; double glazing; secure door entry; and an allocated parking space as well as ample visitor parking.

Situated adjacent to Braehead Shopping Centre, enjoy easy access to a plethora of shops, restaurants, entertainment options, and amenities right at your doorstep. With excellent transport links commuting to Glasgow City Centre and beyond is easily done. Renfrew town centre is also nearby offering a wide variety of amenities.

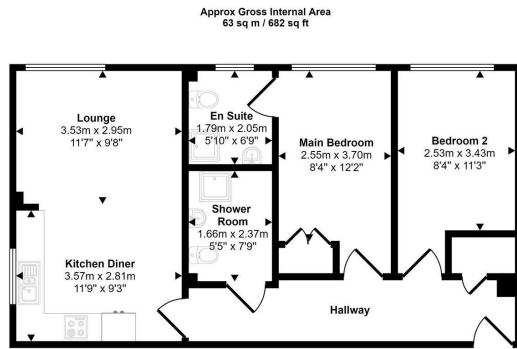

Floorplan

This floorplan is only for illustrative purposes and is not to scale. Measurements of rooms, doors, windows, and any items are approximate and no responsibility is taken for any error, omission or mis-statement. Icons of items such as bathroom suites are representations only and may not look like the real items. Made with Made Snappy 360.

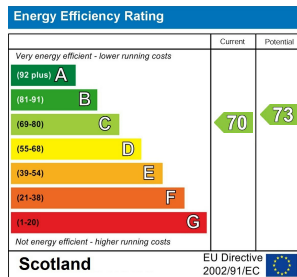

walker laird  
solicitors and estate agents

Renfrew Office  
10 Canal Street, Renfrew, Renfrewshire, PA4 8QD  
Tel: 0141 886 5678 Fax: 0141 886 7327  
estateagency@walkerlaird.co.uk

walkerlaird.co.uk

Disclaimer - IMPORTANT: We would like to inform prospective purchasers that these sales particulars have been prepared as a general guide only. Whilst every precaution has been taken to ensure accuracy, if there is any aspect which is critical to your interest or which you find misleading please contact us for further information. A detailed survey has not been carried out, nor the services, appliances and fittings tested. Room sizes are taken with a laser tape measure, should not be relied upon for furnishing purposes are approximate. Floor plans are for guidance only and illustration purposes only and may not be to scale.